

HYDROSEC TYPE III™

SELF-EXPANDING CORK FILLERBOARD



PRODUCT DESCRIPTION

HydroSEC Type III™ Cork Fillerboard is manufactured to expand according to the ASTM D1752 Type III specification and is manufactured from the bark of the cork oak tree and granulated to be compressed into blocks then cut into sizes to suit your requirements on site.

HydroSEC Type III™ Cork Fillerboard, being a natural based product has the ability to withstand a variety of environmental and climatic conditions. As concrete expands and contracts during daily climate and temperature changes, **HydroSEC Type III™ Cork Fillerboard** automatically adapts to the conditions and prevents your concrete from bursting or cracking.



AREAS OF APPLICATION

- Footpaths
- Driveways
- Pedestrian malls
- Brick or block walls
- Heavy trafficable areas
- Reservoirs
- Dams
- Water treatment plants
- Sewage treatment plants
- Swimming pools
- Ideal for wet areas
- Water tanks
- Highways and bridges
- Airport runways

Note: The product's design and performance, its intended use, installation and final confirmation and approval for use, must be provided by the project's Design Engineer and Project Manager.



PHYSICAL PROPERTIES

PROPERTY	SPECIFICATION	METHOD	UNIT	RESULT
Boiling water expansion (Water, 100°C, 1h)	> 140	ASTM D 545	%	142
Compression - Expansion joints	0.34 - 10.35	ASTM D 545	MPa	0.59
Density (Thickness Method)	250 - 370	ISO 7322	Kg/m ³	313
Recovery - Expansion joint	> 90	ASTM D 545	%	94

Note: The above physical properties are from Certificate of Analysis dated 27/04/2018. Material properties can vary between batches of ± 10%.



TYPICAL APPLICATIONS

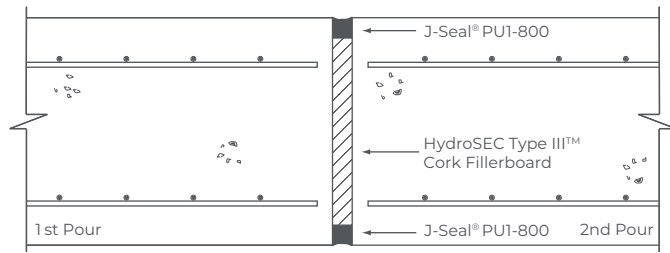

EXPANSION JOINT IN
SLAB OR IN WALL JOINT

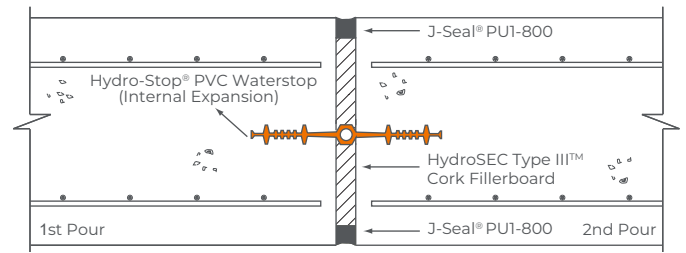

EXPANSION JOINT IN SLAB OR IN WALLJOINT OF
WATER RETAINING /EXCLUDING STRUCTURE



TECHNICAL INFORMATION

➤ WEAR AND TEAR

HydroSEC Type III™ Cork Fillerboard is a semi ridged material manufactured to withstand high traffic movements but still flexible to be able to flex as required in the joint.

➤ NO SYNTHETIC CAPPING/JOINT SEALANT

HydroSEC Type III™ Cork Fillerboard does not require any sealant to prevent the ingress of foreign materials as it will expand to seal the joint when installed in accordance with the ASTM D1752 Type III specification. If specified by the Design Engineer, a Tear Off Cap can be supplied which is being removed after the concrete pour is complete as this can vary in depth as required.

➤ WATERING

As a natural product, **HydroSEC Type III™ Cork Fillerboard** needs to be watered so as to activate the expansion process and achieve a joint seal and so the filament tape must be removed, taking away any concrete slurry exposing the cork and then watering it on a regular basis in accordance with the ASTM D1752 specification.

➤ THICKNESS

HydroSEC Type III™ Cork Fillerboard is available in standard thicknesses of 10, 12, 15, 20 and 25mm and custom thicknesses are also available upon request.

➤ TESTING AND COMPLIANCE

HydroSEC Type III™ Cork Fillerboard is put through many rigorous tests. It is:

- Boiled in hydrochloric acid for 1 hour
- Boiled in water for 1 hour
- Compressed to 50% at a load of 50psi to 1500psi and then recovers to 90% after 10 minutes.
- It then has to meet a density of 354kg / m³

Note : Complies with American Society of Testing of Materials (ASTM 1752-D545 Type III)

➤ PERFORMANCE

- **HydroSEC Type III™ Cork Fillerboard** has the ability to expand up to 25% of its original size
- **HydroSEC Type III™ Cork Fillerboard** expands in boiling water in excess of 170% of its original volume
- It does not extrude from the joint
- It is water resistant and chemically inert
- Resists fungus and vermin
- Maintenance-free with a long life

➤ STORAGE

HydroSEC Type III™ Cork Fillerboard should be stored in a dry place and left in its packaging until you want to use it. We package **HydroSEC Type III™ Cork Fillerboard** to your immediate requirements so it can be carried directly to the site. If you have any left over, it should be sealed again and stored in a dry place for further use.





WRITTEN SPECIFICATION

Where shown in the drawings, the expansion joint fillerboard shall be **HydroSEC Type III™ Cork Fillerboard** manufactured to ASTM D1752 Type III from high grade granulated cork and resin binders, with a minimum density of 250-370kg/m³ and have the ability to expand up to 25%. The application / installation of the product must be in accordance with the manufacturer's recommendations.



HEALTH AND SAFETY INFORMATION

In confined spaces or in still air conditions, the use of a ventilation fan or suitable respirator should be used, and the advice and approval of the Site Safety Supervisor is essential. For further information or advice on health and safety precautions, safe handling, storage and correct disposal of products, please refer to the most recent product Safety Data Sheet (SDS), which is available upon request.



DISCLAIMER

The information and the recommendations relating to the application and end use of this product are given in good faith and are based on the information provided by the manufacturer of the product and/or the Company's current knowledge and experience in connection with the product when properly stored, handled and applied under normal conditions and no liability of final function at the job site is assumed. In practice, the differences in materials substrates and actual site conditions are such that no warranty in respect of merchantability of or fitness for particular purpose, nor any liability arising out of any legal relationship whatsoever, can be inferred either from this information, or from any written and/or oral recommendations, or from any other advice offered by the Company. The Company also has no express or implied knowledge of any particular purpose for which the product is required and any such information given will not be taken into account in the supply of this product. No responsibility or liability by the Company will be accepted for misuse, misreading or derivation from recommended guidelines in respect of this product and the user shall determine the suitability of the product for his intended use and assume all risks and liability in connection therewith. The information contained in our brochure may change at any time without notice. Any use of this product; **HydroSEC Type III™ Cork Fillerboard** in any application should be approved as suitable for use/application by the Design Engineer and Project Manager.

Effective Date: 27 OCTOBER 2020

CJSA

- Unit 2, 18 Farrow Circuit Seaford Rise, South Australia 5169, AUSTRALIA
- +61 432 423 103
- admin@cjsa.net.au

